

Elect flow 1



Elect flow - new generation floodlight

Description

Body in die-cast aluminium with impact-resistant 5 mm flat glass. Powder coated in grey - RAL 7035, corrosion class C5. Smooth surface without visible cooling ribs. Elect is designed to provide maximum heat dissipation and a long lifetime. CLO - Constant Light Output as standard. The fitting complies with EN 62471 requirements for photo-biological safety. Integrated 6kV Surge Protection Device.

Application Areas

Illumination of parking areas, small outdoor spaces, signage, facades, etc. Suitable for commercial buildings, hotels, shopping environments, and public spaces.

Mounting

Designed for mounting in standing, hanging, or wall positions. Supplied with M20 cable gland (6-12mm) and blind plug. Comes with a 2m pre-installed FQQ 2x1.5mm² cable.

On Request

- 10kV Surge Protection Device.
- Alternative power or performance configurations.
- Other cable lengths.
- Night reduction settings.
- Zhaga connector.
- 4000K color temperature.

Light Source

Colour rendering	3000K Ra >70
Colour tolerance	MacAdam 3
Lifetime	100 000h L90B10
Wind surface	0.032 m ²

System efficiency: up to 150 lm/W

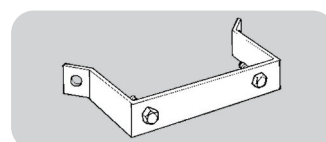
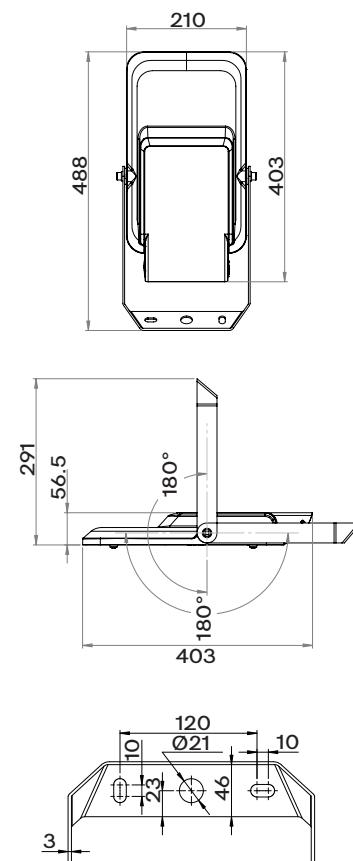

Corner bracket

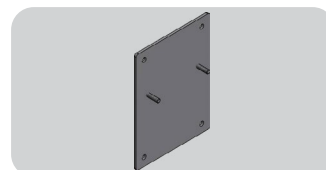

Support plate steel facades or other weak facades.

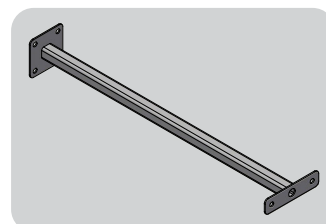

Wall arm

DEFA no.	Type	Light source					Weight (kg)
128816	Elect flow 1	16LED	4200lm	28W	730		3.8kg
128817	Elect flow 1	24LED	9200lm	65W	730		3.8kg

Accessories:

128901	10kV Surge Protection Device with LED indicator
121462	Corner bracket
119802	Support plate 18,5 x 25 cm galv.
129025	Wall arm L=75 cm