



DEFA Balancer™

Item.no: 715004. Optimize utilization of power in a DEFA Power installation.

DEFA Balancer™

Full dynamic load balancing unit

Optimizing use of all available power in your installation. DEFA Balancer monitors power consumption and distributes available power directly to the charging station.

Easy installation — and one solution fits all.

Wireless or wired installation.

DEFA Balancer is compatible with DEFA Power Charging station.

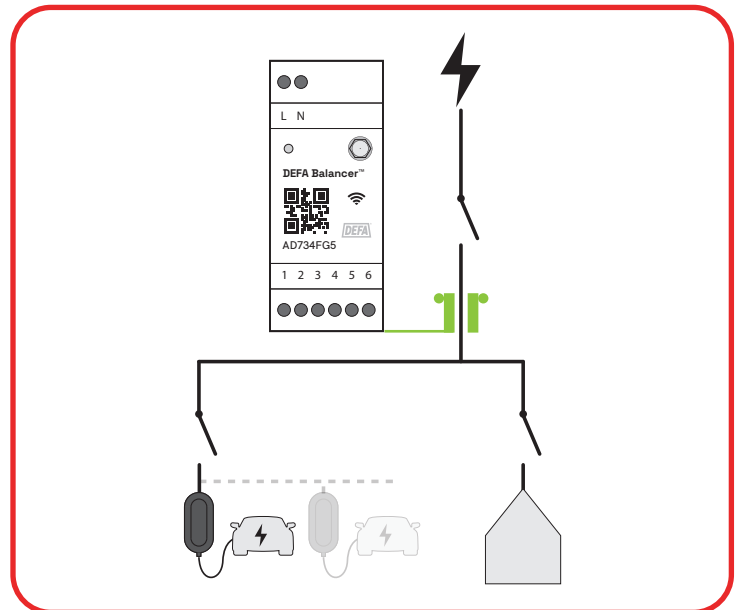

DEFA Power™

Smart EV Charging Station with integrated charging cable. Max 22kW, 32A.

The smartest way to control your power, allowing you to charge at the lowest cost for the maximum output. DEFA Balancer gives you full control of your charging with the available capacity. DEFA Power and Balancer optimizes available power, and with PowerSmart you can avoid peak periods and charging when power is most expensive

DEFA Power — more power to you!

Specification

Dimension:

Number of modular spacings: 2

General:

Product name: DEFA Balancer
Part number: 715004
Product or component type: Current sensor
Product specific application: Load monitoring
Type of measurement: Current
Accuracy: +- 2%
Metering type: Current L1, L2 and L3
Ambient air operating temperature: -25°C to +60°C
Ambient air storage temperature: -30°C to +70°C

Interface:

Transmission medium:
Radio frequency 2.4GHz or 5GHz (Wi-Fi) Ethernet

Current transformers:

Product or component type: Current transformer
Maximum current [I_{max}]: 80A
Measurement type: 0.333V
Cable length: Approx. 100cm

Antenna:

Connector type: SMA male
Connector angle: 90°
Cable length: 1 m
Frequency range: 2.4GHz or 5GHz (Wi-Fi)

Communication:

Transmission medium: Radio frequency 2.4GHz or 5GHz (Wi-Fi) Ethernet
Antenna connector: SMA female

Specification

Safety & protection:

Overvoltage category: II
IP degree of protection: IP20
IK degree of protection: IK06
Pollution degree: 2
Relative humidity: 0...95 % at 55 °C
Appliance class: Class II
Operating altitude: 0...2000m

Standard & certification:

CE
Safety: IEC 61010-1
Radio / EMC: 2014/53/EU - RED

Connection:

Grid: TN / IT / TT
Mounting mode: DIN rail
Cable Entry: 0.2-2.5mm \square
Tightening torque: 0.5Nm
Supply voltage: 230 V AC, +/- 10 %
Frequency: 50/60HZ
Power consumption: 0.03A

Warranty:

5 years (Norway)

Recycling:

Electronic waste

Included:

DEFA Balancer

3 x 80A current sensor

Wi-Fi antenna

