

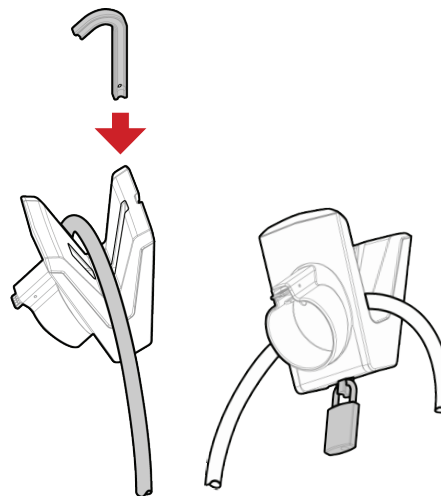

Technical specifications	
Item no:	712268
Size (ex padlock)	91 x 110 x 150mm
Weight	490g
Connection to vehicle	Type 2
Max load on the docking (incl cable)	10kg
Max padlock diameter	5mm
Max cable diameter	19mm



Cable can easily be locked to the docking

## eConnect I docking Type 2

Keep your Type 2 charging cable safe and protected when not in use.

The eConnect docking unit is easily mounted on any wall, and makes it easy to keep your charging cable tidy and protected from theft and from being run over by accident.

The docking unit also prevents water and dirt from entering the plug. Suitable for all Type 2 cables.

### Instructions for use:

Mount the docking unit on the wall next to your charging station or close to where the inlet on your car is usually placed. Lock the coiled cable to the docking unit - with a padlock - to keep it safe when you're not using it. The release tab makes it easy to remove the cable plug from the docking with one hand.

The docking unit can be used with eConnect and any other Type 2 charging cable.

See the user manual for mounting instructions.  
Padlock and cable is not included.