



SmartCharge

Smart battery charger with
even smarter accessories



4A - 6A - 8A - 10A



SmartCharge

easy - safe - user friendly

SmartCharge is an intelligent charger making battery charging safe and easy regardless if you are charging your boat, car, mower or motorcycle. The only thing needed is to connect the charging clips to the battery, connect to a power outlet and push the ON button. SmartCharge will read what type of battery and what status the battery is in to determine what charging is needed. You do not have to think about sparks when connecting or be concerned of overcharging the battery. When you are done, you simply wind up the cables in the cable tracks on the charger and you are ready for the next time you need it.

SmartCharge has built-in power supply mode that gives access to continuous current, for instance when changing the car battery.



AWARD FOR DESIGN EXCELLENCE
NORWEGIAN DESIGN COUNCIL



THE DESIGN FOR ALL AWARD
NORWEGIAN DESIGN COUNCIL

Moottori, a magazine in Finland and Båtmagasinet in Norge conducted a battery charger test and SmartCharge was recommended based on user functionality, design and quality. In addition, SmartCharge has received awards from the Norwegian Design Council (now DOGA).

DEFA SmartCharge

5 variants - incl. 6A Lithium

New!
SmartCharge 6A
Lithium

For all batteries including
LITHIUM

SPARK PROOF CLAMPS
Insulated, high quality
battery clamps.

WEATHERPROOF
IP65

RUBBERIZED SURFACE
FOR SAFER OPERATION

CHARGING STATUS
Intuitive display to follow
the charging process

LITHIUM BATTERY OPTION
Charging process especially
suitable for Lithium batteries

ONE BUTTON SOLUTION
On/Off is all you need

INTEGRATED CABLE SYSTEM
Easy storage of charging cable

SmartCharge is easy to
store as the charging cables
are wound around the
charger and attached to the
side of the housing.

SmartCharge

easy - safe - user friendly

3 SIMPLE STEPS FOR CHARGING YOUR BATTERY!

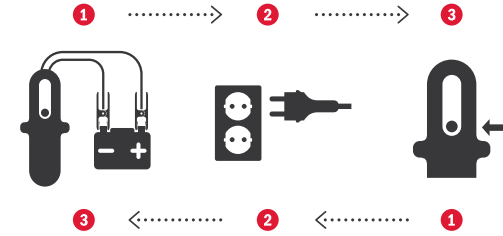

- One-button solution
- Backlights make it easier to use in dark conditions
- Automatically adapt charging to your battery (Ah)
- Will give you status of charging in an easy way
- Integrated cable winding for easy storage and usage
- Temperature compensated charging cycle
- No risk of overloading



It is easy to disconnect the charging cable from the charger, to connect the accessory instead.

Car and other vehicles

Flat battery - with SmartCharge you easily solve the problem

You never know when you are about to have a flat battery – and when you do find out it is particularly irritating. A fast and practical charger is the only solution if you do not want to have to call for assistance. When we use our car every day, it puts a strain on the battery. Modern cars have many electronic features that require a lot of the battery. Most people normally only drive short distances which is not sufficient to charge the battery again while driving. Being a car battery is a tough job – and it is simply not possible to see whether a battery is almost fully charged or discharged. Therefore, we recommend having a portable battery charger on hand.



Attach the clamps to the battery terminals, insert the plug into a power socket and press the ON button. SmartCharge takes care of the rest and on the display you can see when the job is done. On the motorcycle (picture on the left) you can attach the ring terminals on the charging cable directly to the battery and place the indicator where it is visible. Then it is easy to check the battery status and charge in time.



Car and other vehicles

Perfect for cars that are put away for the winter!

Many cars are only used during the summer and these need a special type of recharging. The charging process of SmartCharge enables the charger to be securely connected to the vehicle for a long time. The battery will be fully charged constantly without affecting the lifetime of the battery.



12V charging socket can be used to recharge your battery or as a power supply when you need it.



SmartCharge is ideal for cars that are put in storage for the winter, keeping the battery topped up all winter, e.g. through a retrofitted 12V charging socket.

PowerSupply

Once in a while you need access to continuous current, for instance when replacing the car battery.

PowerSupply is what you need when you do not want to disconnect power and reset all settings in the car, or if you would like to use a 12V unit such as a cooling box. All SmartCharge variants has this function that you easily activate by holding down the ON button for 5 seconds. Your SmartCharge will then produce 13,6V and this is indicated by all 5 LED segments illuminating from bottom to top.

Car and other vehicles

Take care of the Harley, the Vespa and the ATV

It is a long time since small vehicles were fitted with a cord or kick starter. Today, even small mopeds have an electric starter motor and many people find that this luxury is useless with a flat battery. If you have a motorbike, snow scooter or ATV, you will know exactly what we are talking about.

SmartCharge can easily charge the batteries in smaller vehicles, and with the battery indicator it is easy to check the battery status.



Tools and electrical aids

Start the new season with a fully charged battery

The modern home is full of comfortable tools and aids to perform both big and small tasks, summer as well as winter. This could be e.g. snow blowers, lawn mowers or small tractors. Common to many of them is the fact that they have a small, but essential, electric starter motor. Having an electric starter motor means there must be a small battery too, and – just like large batteries – a small battery can become fully discharged and need charging.



SmartCharge adjusts itself to the type of battery and ensures optimal charging no matter what.

SmartCharge accessories

Makes battery charging even easier

Some batteries can be tricky to access. Then it can be useful to have an additional charging cable.

Connect the charging cable to the battery and place the indicator visible. The visible end is not just a dirt-cap to prevent dirt from getting into the charging socket; it is an extremely practical battery indicator! You can easily check the status of your battery via the red, yellow or green light. Could it get any easier?



- 1 Remove the charging cable from the SmartCharge charger by simply pulling out the plug
- 2 Replace the plug with the cable you want to use and attach the clamps / rings directly to the battery, and place the indicator visible so you can check the status of the battery



BATTERY INDICATOR AND WHERE SMARTCHARGE IS CONNECTED



THE CABLE CAN BE PERMANENTLY ATTACHED TO THE BATTERY TERMINALS

Monitor your battery status:

- Must be charged
- Should be charged
- Fully loaded



Boat

Portable smartcharger can help increase safety at sea

Flat starter battery is one of the most common reasons why boat owners need assistance at sea. In a modern boat, there are an increasing amount of equipment that requires power from the battery. In addition, the starter battery in the boat is exposed to both high and low temperatures, and can in many cases be left unused for longer periods. To avoid starting problems and the best possible performance and longevity of the battery it is important to maintain the battery regularly in form of charging and inspection.

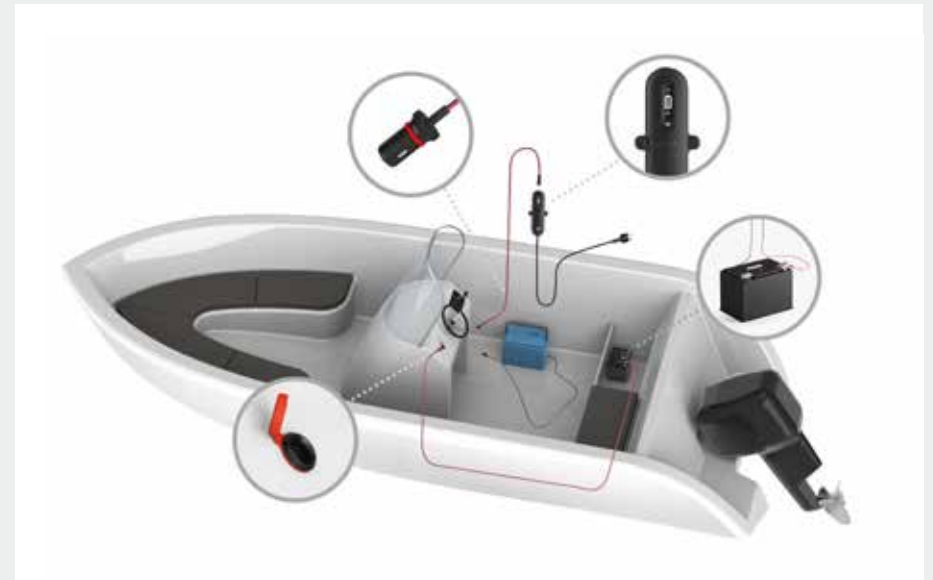

Today, most outboard motors have an electric starter motor, yet very few boats are used in a way which gives trouble-free starting throughout the season. The reason is often that the battery lacks sufficient power to turn the starter motor over and is in need of recharging. SmartCharge is the obvious solution because it is simple and easy to take on board the boat. This is the perfect solution for boats between 13 and 22 feet.



SmartCharge accessories for boat

Easier to check the status of the battery

A simple and useful accessory is the 12V battery indicator. Simply insert it in a 12V charging socket or another 12V outlet, where available, and you can read the status of your battery. If the yellow or red light is illuminated, just take out your SmartCharge. If the green light is illuminated, the battery does not need charging.

BATTERY INDICATOR



Some boats are now supplied with a 12V charging socket installed as standard. It is also very easy to retrofit. With a charging socket fitted, you can easily connect the SmartCharge instead of having to connect the individual battery terminals. It doesn't get any simpler. The socket can also be used to supply power for a cooling box, charging mobile phone, tablet or similar.



SmartCharge



SmartCharge

Variants and accessories

SmartCharge variants:

- 701515: SmartCharge 4A (for battery 4-12Ah)
- 706060: SmartCharge 6A (for battery 10-150Ah)
- 701785: SmartCharge 8A (for battery 20-200Ah)
- 706161: SmartCharge 10A (for battery 30-250Ah)

- 712008: SmartCharge 6A Lithium

SmartCharge

Variants and accessories

SmartCharge is designed to make charging easy. We have therefore developed a range of accessories to make the job even easier. With the 12V charging socket or 12V charging cable, you won't even need to find your way to the battery in order to connect it to SmartCharge.

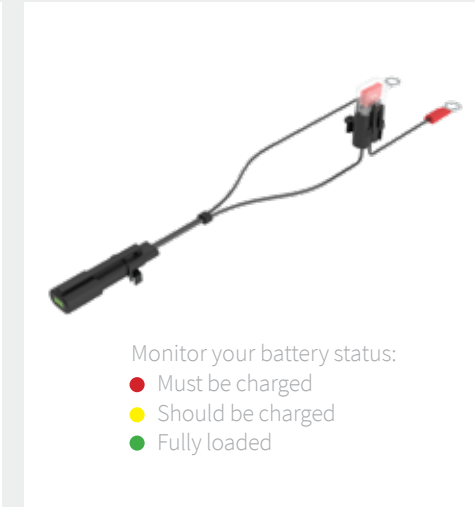
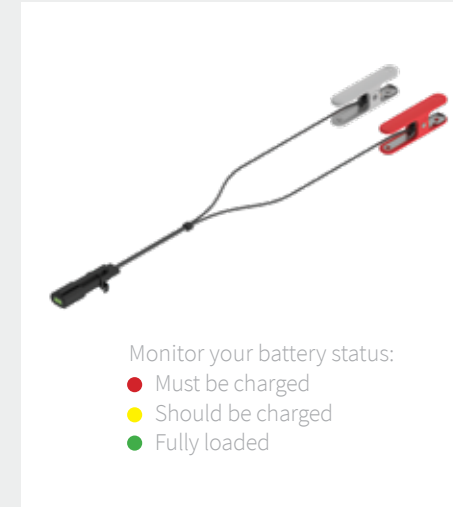
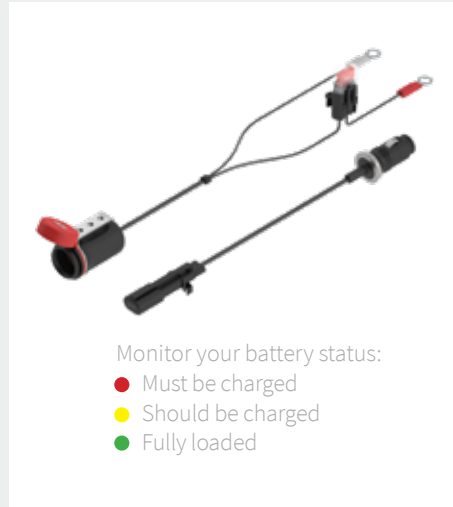
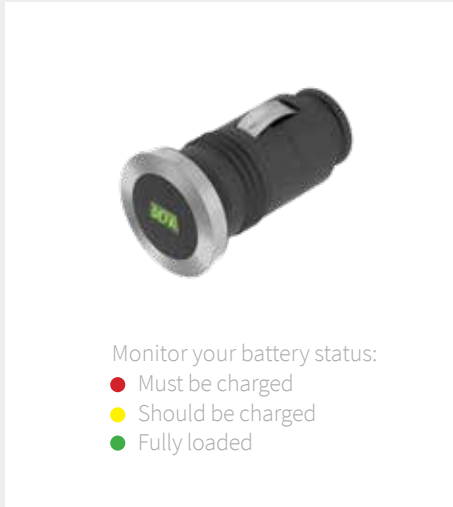

12V Battery Status Indicator

701758: Primary use: Where 12V charging plug is mounted, possibly 12V lighter socket.

12V Charging Cable Kit

701761: Primary use: Caravan, RV, boat. 12V charging cable with rings and battery indicator and 12V charging plug with rings are sold as a complete set.

12V Charging Cable w/ clamps

701764: Primary use: Showrooms, etc. Monitor the power status with the battery status indicator and charge with ease when needed.

12V Charging Cable w/ring terminal

701762: Primary use: MC, ATV, snow scooter, lawn mowers, etc. Permanently mount the cable to your battery.



Dealer:

Read more about SmartCharge: defa.com